REVISED NOTICE OF APPLICATION/SEPA COMMENT PERIOD

This project is being renoticed because some properties were inadvertently omitted from the original comment period that occurred from June 2, 2017 to June 16, 2017. All comments received during the original comment period are still valid. The SEPA is withdrawn and a new SEPA threshold determination will be issued after the revised comment period commences.

Tentative Hearing Date: July 11, 2018; the City website will be updated to reflect the hearing date

The City of Bainbridge Island has received the following land use application:

Date of Issuance: June 1, 2018 (Revised)
Project Name & Number: **Wallace Cottages HDDP PLN50589 SUB**
Project Type: Preliminary Subdivision
Owner: Wallace Cottages LLC
Project Site & Tax Parcel: 27250210232005, 27250211532007, 27250211542006, 27250211552005
Wallace Way between Madison Avenue and Nakata Avenue
Project Description: 19 lot subdivision of four lots totaling 2.5 acres

Environmental Review: This proposal is subject to State Environmental Policy Act (SEPA) review as provided in WAC 197-11-800. The City, acting as lead agency expects to issue a Determination of Non-significance (DNS) threshold determination for this proposal. Utilizing the **optional DNS process** provided in WAC 197-11-355, the comment period specified in this notice may be the only opportunity to comment on the environmental impact of this proposal. The proposal may include mitigation measures under applicable codes, and the project review process may incorporate or require mitigation measures regardless of whether an EIS is prepared. A copy of the subsequent threshold determination for the proposal may be obtained upon request.

Comment period: The City will not take a final action on the proposal nor make a threshold determination for 14 days from the date of this notice. Any person may comment on the proposal and/or the SEPA review. Additionally, any person may participate in a public hearing, if any, and my request a copy of any decision. **For consideration under SEPA environmental review, comments must be submitted by June 15, 2018.**

For questions or to submit comment, contact:

Kelly Tayara, Senior Planner
City of Bainbridge Island
280 Madison Ave North
Bainbridge Island, WA 98110
pcd@bainbridgewa.gov or
206.780.3787

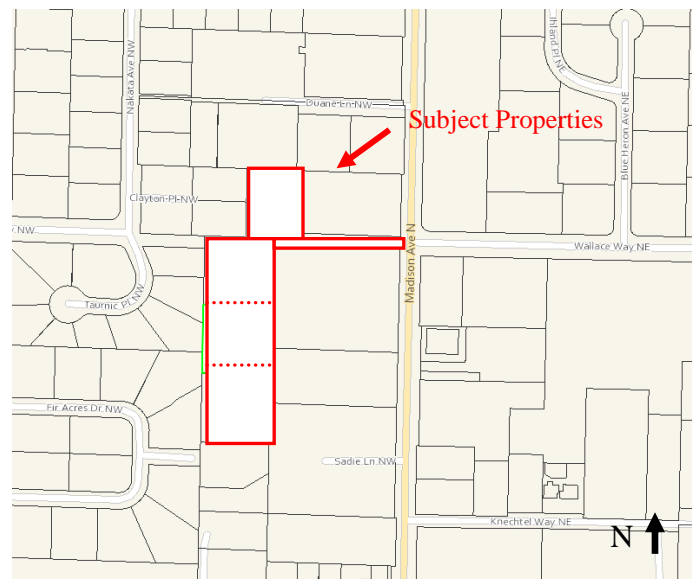

Vicinity Map